

# 411 SPRING

## Quote of the week:

"Life is too  
short to waste  
time hating  
anyone"

By:  
anonymous

## AMERICAN SAMOA COMMUNITY COLLEGE DIVISION OF STUDENT SERVICES

*"Connects Students to What is Happening On Campus"*

March 07, 2011 to March 11, 2011

### 2011 Spring Academic Calendar

March 7 – 11:	<b>SPRING BREAK!!</b>
March 21 – April 8:	<b>Withdrawal Period to Receive a "W/F" or "W/NP"</b>
April 11 – May 6:	<b>2011 Summer &amp; Fall Priority Registration</b>
April 22:	<b>HOLIDAY- Good Friday</b>
April 25 – 28:	<b>ELI &amp; Development MATH Final Examination</b>
April 29:	<b>Last Day to Complete Withdrawal from ASCC</b>
April 29:	<b>Instructions END!!</b>
May 2 – 5:	<b>FINAL EXAMINATIONS!!</b>
May 2 – 5:	<b>ELI 2011 Summer &amp; Fall Priority Registration</b>
May 6 – 11:	<b>Early Add and Drop</b>
May 9:	<b>2011 Spring Semester Graduates Grades DUE!</b>
May 13:	<b>2011 Spring Semester COMMENCEMENT!!</b>
May 18:	<b>ALL 2011 Spring Semester Grades DUE!</b>

### ASTEP 2011 SPRING SESSION

March 14 – 25:	<b>ASTEP Withdrawal Period to Receive a "W/F or W/NP"</b>
April 8:	<b>ASTEP Instructions End</b>

# ASCC MATAI

Alumni Association

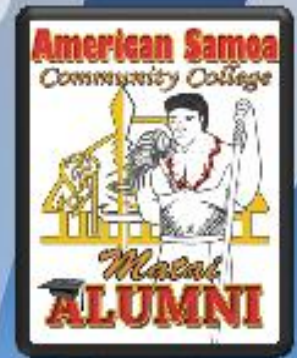

PRESENTS

## ALUMNI IN-HOUSE SCHOLARSHIP FOR NON- PELL STUDENTS

### Eligibility

- Non-Pell Student
- Cum GPA 3.0 or better
- Completed at least 24 credits at ASCC
- Passed Eng 90/91 & Mat 80
- Current Fulltime student for Spring 2011
- Not a recipient of any other in house scholarship

### Required Documents

- Official Transcript or student copy(current)
- 3 letters of Recommendations/ Reference
- 1 page essay
- Copies of I.D. passport or B. Certificate

**Deadline for Applications is March 18, 2011!!**

**FOR MORE INFORMATION OR AN APPLICATION, SEE MANA'O AT  
THE STUDENT LEARNING ASSISTANCE CENTER OR PETERU LAM  
YUEN AT THE ADMISSIONS OFFICE**

**Notice:** For all 2011 Spring & Summer Graduates, please fill out a "Graduate Exit Survey form" with the **ASCC Alumni Counselor, Ms. Matesina Willis.**

**Where?** Student Learning Assistance Center (SLAC) located at the old Book Store before entering the cafeteria.

## University of Oregon **SCHOLARSHIPS** **FOR INTERNATIONAL STUDENTS**

International Affairs, University of Oregon awards over one million dollars in scholarships to UO international students each year. Tuition, cash and work study awards are available. Selection is based on financial need and academic merit.

- **International Cultural Service Program (ICSP):** ~30 new tuition scholarships ranging from \$6,000 - \$20,000. (*Cultural service requirement for recipients.*)
- **International Dean's Excellence Award (IDEA):** ~40 tuition scholarships ranging from \$4,000 - \$6,000. (*Awarded to new students only based on GPA. No application necessary.*)
- **International Affairs Endowed Scholarships:** ~20 cash scholarships ranging from \$1,000 - \$10,000. (*Some scholarships are country-specific.*)
- **International Student Work-Study Program:** ~80 work-study awards ranging from \$500-\$3,000. (*On-campus employment is required.*)



**[international.uoregon.edu/faid](http://international.uoregon.edu/faid)**

Earliest scholarship deadline is February 15, 2011

International Affairs, 5209 University of Oregon, Eugene, OR 97403 • [intl@uoregon.edu](mailto:intl@uoregon.edu)

## **INTERNSHIP OPPORTUNITIES** **Sought for Summer 2011 Undergraduate Scholars**

The NOAA Office of Education (OEd) is seeking NOAA offices and programs nationwide to host Undergraduate Scholarship recipients in the Educational Partnership Program (EPP) and Hollings Scholarship Program. Internship opportunities are sought for 150 scholarship recipients to participate in a 9-week OEd paid internship in NOAA mission-related research, technological, policy, management, and education activities, beginning May 31, 2011.

Starting October 1, 2010, scholarship recipients will begin exploring the internship opportunities posted. Scholars must select an internship by April 1, 2011.

Undergraduate scholars are U.S. citizens and full-time undergraduate students majoring in NOAA mission-related disciplines, including, but not limited to, oceanic, environmental, and atmospheric sciences, mathematics, engineering, remote sensing technology, physical and social sciences including, geography, physics, hydrology, and teacher education. Scholarship recipients receive an OEd-funded award that includes academic assistance, a 10-week paid internship, housing assistance, conference travel, and round-trip travel to the internship site.

Host offices are requested to identify a discrete project that the undergraduate scholar can complete within a 9-week timeframe. Internship opportunities must be submitted in the Student Scholarship Internship Opportunity (SSIO) on-line system. To access the SSIO, go to <https://ssio.iso.noaa.gov>. The SSIO is open for past and potential NOAA mentors to view, update, delete, or create new internship opportunities.

For more information, please contact: Dean of Student Services

Courtesy of Student Services Division  
Counseling Services  
Spring 2011

## CALLING ALL... Faga'itua high school alumni!

The Faga'itua High School Alumni Association is offering a one-time **college scholarship** for FHS alumni members attending off-island colleges and universities as well as ASCC. Criteria are as follow:

- Verification for G.P.A of 2.5 or above
- Verification of enrollment for the following semester
- A letter of recommendation from (Professor, Administrator, Minister, or Employer)
- Applicant must be a Faga'itua High School Alumni (need copy of high school diploma)

Please see or contact Mana'o Vaovasa at the SLAC office for an application. Don't miss out!

**Deadline: April 22, 2011**

## INTERNATIONAL BROADCASTERS' IDEABANK, Inc. (IBIB) *SESAC Radio Scholarship Grant Information*



1. One scholarship of \$7,500 will be awarded to a junior or senior (as of September 2011) at a college or university that offers undergraduate training in radio broadcasting and/or music related programs, such as advertising, mass media, communications, journalism, or music studies. Some radio experience is considered as a positive, but is not required. This scholarship is funded by SESAC, a music licensing company, ([www.sesac.com](http://www.sesac.com)) which contracts with radio stations for the rights to broadcast their material. If you have questions, contact the radio station that offers this award; do not contact SESAC.

2. In order to qualify for the grant, the applicant must meet the following conditions:

- Is now attending, and is in good standing, a college or university in the United States. Freshmen students are not eligible. You must be at least a sophomore as of February 2011.
- Select a course of study relating to a career in radio broadcasting, journalism and/or music.
- Exhibit grades in previous academic work, which, in the judgment of the IBIB, are adequate to give reasonable assurance of success in earning a degree in a program, outlined above.
- Be of good moral character.
- Supply all of the information requested on the *Official Scholarship Application Form*.
- Intend to pursue a career which includes radio broadcasting, journalism or music.

3. Applicants must return forms to: Scholarship Committee, IBIB, PO Box 2448, Danville, VA 24541-0448, postmarked in time to arrive before the deadline (see Rule 4, below). (Street address for UPS/FedEx only: 129 Acorn Lane, Danville, VA 24541) **For items sent by Express Mail, be sure to check the box that indicates NO signature is needed by the recipient. This mail is going to a Post Office box and requiring a signature only delays**

Courtesy of Student Services Division  
Counseling Services  
Spring 2011

your entry.

4. ABSOLUTE DEADLINE FOR RECEIPT: All application forms, essays, and transcripts must be *received* by **March 7, 2011**. If *all* of these are not received by the deadline, the application will not be considered. Please inform your college of this deadline for your transcripts.

## **COUNSELING SERVICES OFFICE:** *Located in the cafeteria*

- ***Student Transferability***

Prospective graduates of Spring & Fall 2011 must come in to see their offices located in the cafeteria for the following:

- **Fill out an Exit Counseling Survey**
- **Transferring to a 4-year college or university for assistance** with college search, filling out college applications, and retrieving college document checklists
- **Students seeking assistance in resume writing or job coaching**  
\*If you have any problems seeing any of the counselors in person, you can contact them via interoffice extensions or email: Matesina ext. 461 {m.willis@amsamo.edu}, Annie ext. 362 {a.panama@amsamo.edu}, or Mark ext. 326 {m.mageo@amsamo.edu}



counselors at

with

- ***Tutorial (FREE)***

- Students interested in getting tutored in any subject, please come see us at the Student Learning Assistance Center (SLAC) Office☺
- All tutorials are free and appointments are made with Deidra Saelua {d.saelua@amsamo.edu}, Lydian Tinali {l.tinali@amsamo.edu}, Gwen Emmsley or any of the available staff members at the SLAC or call ext. 461.



- ***Personal and Academic Counseling / Peer Counseling / YANA***

- Students who have any personal issues such as: peer pressure, family issues, thoughts of suicide, relationship problems, dealing with emotional distress, and just need someone to talk to... please see the Personal Counselor- Mark Mageo or call 252-YANA (9262) or email: [yana@amsamo.edu](mailto:yana@amsamo.edu)
- 

- ***Student Employment (Non-Pell) / VA Student Services, Acting Coordinator***

Please notify your veteran population.

Subject: You may be eligible for Retroactive Stop Loss Special Pay (RSLSP), \$500 a month. As a recipient of funds under the G.I. Bill, the following message may apply to you. Service Members involuntarily held under Stop Loss Authority between 11 September 2001 and 30 September 2008 qualify for RSLSP. Those eligible will receive \$500 for every month spent in a stop loss status. Those who Served in the Army should apply for the special day at <https://www.stoplosspay.army.mil>.

Please do not file a hard copy claim; use the secure web site to file your claim.

For other services, visit <http://www.defense.gov/stoploss>.

If you have already applied for stop loss pay, disregard this message.

For more information, contact Ms. Rosie Lancaster at 699-9155 ext. 426, Email:

[f.lancaster@amsamo.edu](mailto:f.lancaster@amsamo.edu), or the VA Student Services office behind the cafeteria.

## SGA ACTIVITY CALENDAR Spring Semester 2011

### MARCH

		S	M	T	W	T	F	S
				1	2	3	4	5
7-11	SPRING BREAK (ARRA Commercial Shooting)	6	7	8	9	10	11	12
15, 17, 22&24	INTRAMUARALS@GYM 12:30-2:00pm (ARRA Out Reach High Schools)	13	14	15	16	17	18	19
21-April 8	Withdrawal period to receive a "W/F" or "W/NP"	20	21	22	23	24	25	26
29	WORKSHOP/Lecture Hall 12:30pm-2:00pm (Teen Pregnancy)	27	28	29	30	31		
31	Club Field Day (Olympic Games)							

### APRIL

		S	M	T	W	T	F	S
5	Easter Egg Hunt Competition (Field Games 12:30-2:00pm)							
11-May 6	2011 Summer & Fall Priority Registration						1	2
12	3 <sup>rd</sup> ACTIVITY (Poster Contest ARRA)	3	4	5	6	7	8	9
14	CLUB CLEAN UP DAY (ASCC Campus)	10	11	12	13	14	15	16
19	SGA Mtg. S2011 /President 12:30-2:00pm	17	18	19	20	21	22	23
22	HOLIDAY-Good Friday	24	25	26	27	28	29	30
26-27	Continental Breakfast/Outreach Deadline ARRA High School contest							
28	CLUB AWARDS/Falesamoa 12:30pm-2:00pm/Winners of Outreach							
29	Last Day for complete withdrawal from ASCC & Instructional End							

### MAY

		S	M	T	W	T	F	S
2-5	Final Examination & ELI Summer & Fall Priority Registration							
6-11	Early Add & Drop	1	2	3	4	5	6	7
9	2011 Semester Graduate Grades Due	8	9	10	11	12	13	14
13	2011 Spring Semester Commencement	15	16	17	18	19	20	21
18	All 2011 Spring Semester Grades Due	22	23	24	25	26	27	28
		29	30	31				

### "The Veterans Educational Assistance Improvements Act of 2010"

Was signed into law by the President on January 4, 2011. The law makes some significant changes, primarily to the Post 9/11 (Ch 33) GI Bill but it also impacts other Education Programs. Here are some changes under Public Law (P.L.) 111-377 to VA benefits:

(list them as stated in the slide)

Further questions should be addressed or directed to the ASCC, Veterans Student Coordinator, Ms. Rosie Tago Lancaster, 699-9155, ext. 426.

#### Provisions of the law:

- **Effective now but not payable until Oct 1, 2011:**  
Expands the Post-9/11 GI Bill to include certain Active Service performed by National Guard members who served under title 32 U.S.C. for the purpose of organizing, administering, recruiting, instructing, or training the National Guard; or under section 502(f) for the purpose of responding to a national emergency.
- **Effective March 3, 2011:**  
Limits active duty members pursuing a degree at more than half-time to the net cost for tuition and fees prorated based on the eligibility tiers (40% - 100%) previously established for Veterans.  
Same limitations apply to transferee spouses of active duty service members.

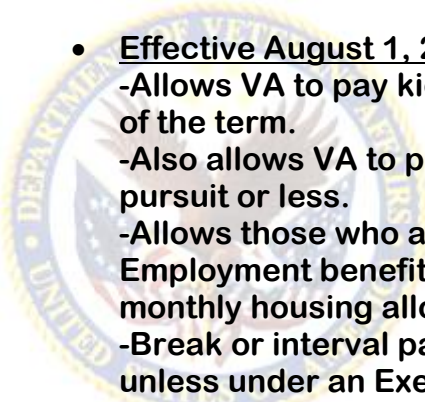

- **Effective August 1, 2011:**

- Allows VA to pay kickers on a monthly basis instead of a lump sum at the beginning of the term.
- Also allows VA to pay kickers to those who are attending school at a half-time rate of pursuit or less.
- Allows those who are eligible for both Ch 31 Vocational Rehabilitation and Employment benefits and Post-9/11 GI Bill benefits to choose the Post-9/11 GI Bill's monthly housing allowance instead of the Chapter 31 subsistence allowance.
- Break or interval pay is no longer payable under any VA education benefit program unless under an Executive Order of the President or due to an emergency situation such as a natural disaster or strike.

## **Financial Aid**

### **FEDERAL WORK STUDY TIMESHEET DEADLINES**

Pay Period 4 Start Date: 03/07/2011 End Date: 03/18/11 Timesheet Due: **Mar.21<sup>st</sup>**  
Pay Period 5 Start Date: 03/21/2011 End Date: 04/01/11 Timesheet Due: **Apr.4<sup>th</sup>**

Please make sure that timesheets are accurate and are **turned in before 10am** to Sesilia Luapo. Inaccurate timesheets will be returned. Questions call 699-9155 x313

**NOTE:** Work study students are allowed to work a maximum of 65 hours. Please see Sesilia for your balance after each pay period.

### **SPRING 2011 ATTENDANCE FORMS**

**Deadline for Attendance forms for spring is April 27<sup>th</sup>; failure to meet deadline will result in awaiting grades to be posted in order to be batched. NOTE: Financial Aid does not pay for failed courses.**

**REMINDER:** The financial aid office will ONLY process financial aid for students that have the following:

- Complete Financial Aid application ([Apply online www.fafsa.ed.gov](http://www.fafsa.ed.gov)) **ASCC School Code 010010; takes a minimum of 3 business days for ASCC to receive application.**
- High School transcript (**required only for students that have graduated after 1/1/05**)
- Copies of the following documents **provided by Originals:**
  - High School diploma / Transcripts**
  - Local Government ID**
  - Birth Certificate and/or US Passport**
  - Social Security Card**
  - Attendance form (complete with signatures from instructors)**

**Appointments with Counselors:** You may make an appointment to see your counselor for assistance with your FAFSA corrections or any other inquiries. Counselors are available every Friday, as they will be processing batches Monday-Thursday. We appreciate your patience.

### **DOCUMENTS! DOCUMENTS! DOCUMENTS!**

Have you been contacted by your counselors to turn in documents? If so, the sooner the better! Please turn in documents to our front desk receptionist.

Courtesy of Student Services Division  
Counseling Services  
Spring 2011

## WHAT BATCH NUMBER AM I ON?

You will be notified of your batch number either by email, mail, or come by our office with your student ID. **No phone inquiries please.** Batch number release information will be posted on our Bulletin Board. If you see your batch number on board please see your counselor for your clearance form.

\*\*\*All batches will be released at 3pm at the Business Office. Any questions on your charges should be directed to the Business Office\*\*\*

### LIBRARY

The library now has a Suggestion Box. The library welcomes any comments students, staff and faculty may have to improve the library's services as well as any book, magazine or movie suggestions they would like the library to carry.

### BUSINESS OFFICE

\* If you have any questions pertaining to your tuition payment, please see Moala Mago or Benjamin Ah Siu at the Business Office.

#### Credit & Collections

**To all students!** "Notice for Payment". We would like to remind all students with an outstanding balance on their account, they are required to clear and pay off any amount due to ASCC before registering for the new and upcoming semester, also if not currently on a deferred payment plan, must make arrangements immediately for repayment. Any other inquiries or concerns, please do not hesitate to contact us. *Vaesavali Ta'ala, ext.311 (v.taala@amsamoa.edu), Carmen Umi ext.383 (c.umi@amsamoa.edu)*

## EVENING CLASSES!

For your convenience, the following rooms are available after hours:  
Monday – Thursday; 4pm – 7:30pm

- 1) Computer Lab
- 2) Library
- 3) Student Learning Assistance Center (SLAC)

**Note:** *The following services are also available at the Student Learning Assistance Center, located next to the Cafeteria.*

- 1) Counseling
  - 2) Tutorials
  - 3) Xerox Services
- Note:

**Must have student ID to pick pass for evening classes ONLY!!**



# English Tutorial Service Schedule: Spring 2011

Hours	Monday	Tuesday	Wednesday	Thursday	Friday
<b>8:00-9:00</b>	<u>Tutors:</u> -Denis Lambert -Maelise Vai -Marily F-Griffin -Nerisa Maiava -Nolita Motu	<u>Tutors:</u> -Bambridge Lin -Denis Sene -Falen Ulu. -Felix Penalosa -Juliano McM. -Marietta Lafaele -Nolita Motu -Rani Anandan -Sabrina Sulua'i -Amber Fuaga	<u>Tutors:</u> -Denis Lambert -Maelise Vai -Marily F-Griffin -Nerisa Maiava -Nolita Motu	<u>Tutors:</u> -Bambridge Lin -Denis Sene -Falen Ulu. -Felix Penalosa -Juliano McM. -Marietta Lafaele -Nolita Motu -Rani Anandan -Sabrina Sulua'i - Amber Fuaga	<u>Tutors:</u> -Denis Lambert -Maelise Vai -Marily F-Griffin -Nerisa Maiava -Nolita Motu
<b>9:00-10:00</b>	<u>Tutors:</u> -Maelise Vai -Nerisa Maiava -Nolita Motu	<u>Tutors:</u> -Bambridge Lin -Denis Sene -Denis Lambert -Falen Ulu. -Felix Penalosa -Juliano McM. -June Fuifatu -Marietta Lafaele -Nolita Motu -Rani Anandan -Sabrina Sulua'i -Amber Fuaga	<u>Tutors:</u> -Maelise Vai -Nerisa Maiava -Nolita Motu	<u>Tutors:</u> -Bambridge Lin -Denis Sene -Denis Lambert -Falen Ulu. -Felix Penalosa -Juliano McM. -June Fuifatu -Marietta Lafaele -Nolita Motu -Rani Anandan -Sabrina Sulua'i -Amber Fuaga	<u>Tutors:</u> -Maelise Vai -Nerisa Maiava -Nolita Motu
<b>10:00-11:00</b>	<u>Tutors:</u> -Angialena Sunia -Felix Penalosa -Juliano McM. -Kristina Vernes -Mercy Parungo -Monica Afalava -Nerisa Maiava -Nolita Motu -Rani Anandan -Sala Ta'ase -Susitina Ene -Toefuataina T.	<u>Tutors:</u> -Angialena Sunia -BambridgeLin -Denis Sene -Falen Ulu. -Felix Penalosa -June Fuifatu -Marietta Lafaele -Monica Afalava -Nolita Motu -Rani Anandan -Sabrina Sulua'i -Toefuataina T. -Amber Fuaga	<u>Tutors:</u> -Angialena Sunia -Felix Penalosa -Juliano McM. -Kristina Vernes -Mercy Parungo -Monica Afalava -Nerisa Maiava -Nolita Motu -Susitina Ene	<u>Tutors:</u> -Angialena Sunia -BambridgeLin -Denis Sene -Falen Ulu. -Felix Penalosa -June Fuifatu -Marietta Lafaele -Monica Afalava -Nolita Motu -Rani Anandan -Sabrina Sulua'i -Toefuataina T. - Amber Fuaga	<u>Tutors:</u> -Angialena Sunia -Felix Penalosa -Juliano McM. -Kristina Vernes -Mercy Parungo -Monica Afalava -Nerisa Maiava -Nolita Motu -Rani Anandan -Sala Ta'ase -Susitina Ene -Toefuataina T.
<b>11:00-12:00</b>	<u>Tutors:</u> -BambridgeLin -Chadwick L.Y.	<u>Tutors:</u> -Angialena Sunia -BambridgeLin	<u>Tutors:</u> -BambridgeLin -Chadwick L.Y.	<u>Tutors:</u> -BambridgeLin -Carly Toia	<u>Tutors:</u> -Chadwick L.Y. -Denis Lambert

Courtesy of Student Services Division  
Counseling Services  
Spring 2011

-Denis Lambert  
-Felix Penalosa  
-Kristina Vernes  
-Mercy Parungo  
-Monica Afalava  
-Nerisa Maiava  
-Nolita Motu  
-Rani Anandan  
-Sala Ta'ase  
-Susitina Ene  
-Toefuataina T.

-Carly Toia  
-Denis Sene  
-Falen Ulu.  
-Felix Penalosa  
-June Fuifatu  
-Marietta Lafaele  
-Mercy Parungo  
-Monica Afalava  
-Nolita Motu  
-Rani Anandan  
-Sabrina Sulua'i  
-Toefuataina T.  
-Amber Fuaga

-Denis Lambert  
-Felix Penalosa  
-Kristina Vernes  
-Mercy Parungo  
-Monica Afalava  
-Nerisa Maiava  
-Nolita Motu  
-Susitina Ene

-Denis Sene  
-Falen Ulu.  
-Felix Penalosa  
-June Fuifatu  
-Marietta Lafaele  
-Mercy Parungo  
-Monica Afalava  
-Nolita Motu  
-Rani Anandan  
-Sabrina Sulua'i  
-Toefuataina T.  
-Amber Fuaga

-Felix Penalosa  
-Kristina Vernes  
-Mercy Parungo  
-Monica Afalava  
-Nerisa Maiava  
-Nolita Motu  
-Rani Anandan  
-Sala Ta'ase  
-Susitina Ene  
-Toefuataina T.

**12:00-1:00**

Tutors:  
-Angialena Sunia  
-BambridgeLin  
-Chadwick L.Y.  
-Felix Penalosa  
-Juliano McM.  
-Monica Afalava  
-Nolita Motu  
-Sabrina Sulua'i  
-Sala Ta'ase  
-Susitina Ene  
-Toefuataina T.

Tutors:  
-Angialena Sunia  
-BambridgeLin  
-Carly Toia  
-Denis Sene  
-Falen Ulu.  
-Felix Penalosa  
-June Fuifatu  
-Maelise Vai  
-Marietta Lafaele  
-Mercy Parungo  
-Monica Afalava  
-Nerisa Maiava  
-Rani Anandan  
-Sabrina Sulua'i  
-Toefuataina T.  
-Amber Fuaga

Tutors:  
-Angialena Sunia  
-BambridgeLin  
-Chadwick L.Y.  
-Felix Penalosa  
-Juliano McM.  
-Monica Afalava  
-Nolita Motu  
-Sabrina Sulua'i  
-Susitina Ene

Tutors:  
-Angialena Sunia  
-BambridgeLin  
-Carly Toia  
-Denis Sene  
-Falen Ulu.  
-Felix Penalosa  
-June Fuifatu  
-Maelise Vai  
-Marietta Lafaele  
-Mercy Parungo  
-Monica Afalava  
-Nerisa Maiava  
-Rani Anandan  
-Sabrina Sulua'i  
-Toefuataina T.  
-Amber Fuaga

Tutors:  
-Angialena Sunia  
-BambridgeLin  
-Chadwick L.Y.  
-Felix Penalosa  
-Juliano McM.  
-Monica Afalava  
-Nolita Motu  
-Sabrina Sulua'i  
-Sala Ta'ase  
-Susitina Ene  
-Toefuataina T.

**1:00-2:00**

Tutors:  
-Carly Toia  
-Chadwick L.Y.  
-Denis Sene  
-Felix Penalosa  
-June Fuifatu  
-Juliano McM.  
-Nolita Motu  
-Sabrina Sulua'i  
-Sala Ta'ase  
-Susitina Ene  
-Toefuataina T.

Tutors:  
-Angialena Sunia  
-Chadwick L.Y.  
-Denis Lambert  
-Felix Penalosa  
-Juliano McM.  
-June Fuifatu  
-Kristina Vernes  
-Maelise Vai  
-Monica Afalava  
-Nerisa Maiava  
-Sabrina Sulua'i  
-Sala Ta'ase  
-Susitina Ene  
-Toefuataina T.

Tutors:  
-Carly Toia  
-Chadwick L.Y.  
-Denis Sene  
-Felix Penalosa  
-Juliano McM.  
-Marily F-Griffin  
-Nolita Motu  
-Sabrina Sulua'i  
-Sala Ta'ase  
-Susitina Ene

Tutors:  
-Angialena Sunia  
-Chadwick L.Y.  
-Denis Lambert  
-Felix Penalosa  
-Juliano McM.  
-June Fuifatu  
-Kristina Vernes  
-Maelise Vai  
-Monica Afalava  
-Nerisa Maiava  
-Sabrina Sulua'i  
-Sala Ta'ase  
-Susitina Ene  
-Toefuataina T.

Tutors:  
-Carly Toia  
-Chadwick L.Y.  
-Felix Penalosa  
-Juliano McM.  
-June Fuifatu  
-Nolita Motu  
-Sabrina Sulua'i  
-Sala Ta'ase  
-Susitina Ene  
-Susitina Ene  
-Toefuataina T.

**2:00-3:00**Tutors:

-Carly Toia  
 -Chadwick L.Y.  
 -Denis Sene  
 -Denis Lambert  
 -Falen Ulu.  
 -Felix Penalosa  
 -June Fuifatu  
 -Marily F-Griffin  
 -Monica Afalava  
 -Nerisa Maiava  
 -Nolita Motu  
 -Rani Anandan  
 -Sabrina Sulua'i  
 -Sala Ta'ase  
 -Susitina Ene

Tutors:

-Angialena Sunia  
 -Chadwick L.Y.  
 -Denis Lambert  
 -Felix Penalosa  
 -Kristina Vernes  
 -Maelise Vai  
 -Monica Afalava  
 -Nerisa Maiava  
 -Sabrina Sulua'i  
 -Sala Ta'ase  
 -Susitina Ene  
 -Toefuataina T.

Tutors:

-Carly Toia  
 -Chadwick L.Y.  
 -Denis Sene  
 -Denis Lambert  
 -Falen Ulu.  
 -Felix Penalosa  
 -Marily F-Griffin  
 -Monica Afalava  
 -Nerisa Maiava  
 -Nolita Motu  
 -Sabrina Sulua'i  
 -Sala Ta'ase  
 -Susitina Ene

Tutors:

-Angialena Sunia  
 -Chadwick L.Y.  
 -Denis Lambert  
 -Felix Penalosa  
 -Juliano McM.  
 -Kristina Vernes  
 -Maelise Vai  
 -Monica Afalava  
 -Nerisa Maiava  
 -Sabrina Sulua'i  
 -Sala Ta'ase  
 -Susitina Ene  
 -Toefuataina T.

Tutors:

-Carly Toia  
 -Chadwick L.Y.  
 -Denis Lambert  
 -Falen Ulu.  
 -Felix Penalosa  
 -June Fuifatu  
 -Marily F-Griffin  
 -Monica Afalava  
 -Nerisa Maiava  
 -Nolita Motu  
 -Rani Anandan  
 -Sabrina Sulua'i  
 -Sala Ta'ase  
 -Susitina Ene

**3:00-4:00**Tutors:

-Angialena Sunia  
 -Carly Toia  
 -Denis Sene  
 -Denis Lambert  
 -Falen Ulu.  
 -Felix Penalosa  
 -June Fuifatu  
 -Marily F-Griffin  
 -Monica Afalava  
 -Nolita Motu  
 -Sabrina Sulua'i  
 -Sala Ta'ase  
 -Susitina Ene

Tutors:

-Angialena Sunia  
 -Chadwick L.Y.  
 -Denis Lambert  
 -Felix Penalosa  
 -Kristina Vernes  
 -Maelise Vai  
 -Monica Afalava  
 -Nerisa Maiava  
 -Sala Ta'ase  
 -Susitina Ene  
 -Toefuataina T.

Tutors:

-Angialena Sunia  
 -Carly Toia  
 -Denis Sene  
 -Denis Lambert  
 -Felix Penalosa  
 -Monica Afalava  
 -Nolita Motu  
 -Sabrina Sulua'i  
 -Sala Ta'ase  
 -Susitina Ene

Tutors:

-Angialena Sunia  
 -Chadwick L.Y.  
 -Denis Lambert  
 -Felix Penalosa  
 -Kristina Vernes  
 -Maelise Vai  
 -Monica Afalava  
 -Nerisa Maiava  
 -Sala Ta'ase  
 -Susitina Ene  
 -Toefuataina T.

Tutors:

-Angialena Sunia  
 -Carly Toia  
 -Denis Lambert  
 -Felix Penalosa  
 -June Fuifatu  
 -Marily F-Griffin  
 -Monica Afalava  
 -Nolita Motu  
 -Sabrina Sulua'i  
 -Sala Ta'ase  
 -Susitina Ene

**4:00-5:00**

Tutors:  
 Counselors

Tutors:  
 Counselors

Tutors:  
 Counselors

Tutors:  
 Counselors

Tutors:  
 No Evening Classes

**5:00-6:00**

Tutors:  
 Counselors

Tutors:  
 Counselors

Tutors:  
 Counselors

Tutors:  
 Counselors

No Evening Classes

**6:00-7:30**

**Tutors:  
 Counselors**

**Tutors:  
 Counselors**

**Tutors:  
 Counselors**

**Tutors:  
 Counselors**

**No Evening  
 Classes**

**MATH & SCIENCE TUTORIAL SCHEDULE SPRING 2011**  
**MATH 80 – MATH 280/PHYSICAL SCIENCE/BIOLOGY/CHEMISTRY**

<b>HOURS</b>	<b>MONDAY</b>	<b>TUESDAY</b>	<b>WEDNESDAY</b>	<b>THURSDAY</b>	<b>FRIDAY</b>
<b>8:00 – 9:00</b>	Denis Lambert Lila Tuilagi Motusaga Vaeao Raelynn Mapu	Atene Ulimasao Denis Sene Falen Ulufaleilupe Felix Penalosa Karl Cayanan Marietta Lafaele Sabrina Sulua'i Senetenari Malele	Denis Lambert Lila Tuilagi Motusaga Vaeao Raelynn Mapu	Atene Ulimasao Denis Sene Falen Ulufaleilupe Felix Penalosa Karl Cayanan Marietta Lafaele Sabrina Sulua'i Senetenari Malele	Denis Lambert Lila Tuilagi Motusaga Vaeao Raelynn Mapu
<b>9:00 – 10:00</b>	Karl Cayanan Motusaga Vaeao Nerisa Maiava Raelynn Mapu	Atene Ulimasao Denis Sene Felix Penalosa Karl Cayanan Marietta Lafele Senetenari Malele	Karl Cayanan Motusaga Vaeao Nerisa Maiava Raelynn Mapu	Atene Ulimasao Denis Sene Felix Penalosa Karl Cayanan Marietta Lafele Senetenari Malele	Karl Cayanan Motusaga Vaeao Nerisa Maiava Raelynn Mapu
<b>10:00 – 11:00</b>	Angialena Sunia Atene Ulimasao Felix Penalosa Kristina Vernes Monica Afalava Nerisa Maiava Oina Salu Shawntiarre Faumui Susitina Ene	Angialena Sunia Denis Sene Falen Ulufaleilupe June Fuifatu Karl Cayanan Monica Afalava Senetenari Malele	Angialena Sunia Atene Ulimasao Felix Penalosa Kristina Vernes Monica Afalava Nerisa Maiava Oina Salu Shawntiarre Faumui Susitina Ene	Angialena Sunia Denis Sene Falen Ulufaleilupe June Fuifatu Karl Cayanan Monica Afalava Senetenari Malele	Angialena Sunia Atene Ulimasao Felix Penalosa Kristina Vernes Monica Afalava Nerisa Maiava Oina Salu Shawntiarre Faumui Susitina Ene
<b>11:00 – 12:00</b>	Atene Ulimasao Denis Lambert Felix Penalosa Karl Cayanan Kristina Vernes Monica Afalava Oina Salu Shawntiarre Faumui Susitina Ene	Atene Ulimasao Carly Toia Felix Penalosa Karl Cayanan Raelynn Mapu Senetenari Malele Shane Chen	Atene Ulimasao Denis Lambert Felix Penalosa Karl Cayanan Kristina Vernes Monica Afalava Oina Salu Shawntiarre Faumui Susitina Ene	Atene Ulimasao Carly Toia Felix Penalosa Karl Cayanan Raelynn Mapu Senetenari Malele Shane Chen	Atene Ulimasao Denis Lambert Felix Penalosa Karl Cayanan Kristina Vernes Monica Afalava Oina Salu Shawntiarre Faumui Susitina Ene
<b>12:00 – 1:00</b>	Alesana Alesana Angialena Sunia June Fuifatu Lila Tuilagi Monica Afalava Oina Salu Sabrina Sulua'i	Carly Toia Falen Ulufaleilupe Marietta Lafaele Monica Afalava Sabrin Sulua'i	Alesana Alesana Angialena Sunia June Fuifatu Lila Tuilagi Monica Afalava Oina Salu Sabrina Sulua'i	Carly Toia Falen Ulufaleilupe Marietta Lafaele Monica Afalava Sabrin Sulua'i	Alesana Alesana Angialena Sunia June Fuifatu Lila Tuilagi Monica Afalava Oina Salu Sabrina Sulua'i
<b>1:00 – 2:00</b>	Atene Ulimasoe Carly Toia Denis Sene Felix Penalosa June Fuifatu Lila Tuilagi Raelynn Mapu Sabrina Sulua'i Shane Chen	Alesana Alesana Angialena Sunia Denis Lambert Kristina Vernes Nerisa Maiava Raelynn Mapu Shawntiarre Faumui Susitina Ene	Atene Ulimasoe Carly Toia Denis Sene Felix Penalosa June Fuifatu Lila Tuilagi Raelynn Mapu Sabrina Sulua'i Shane Chen	Alesana Alesana Angialena Sunia Denis Lambert Kristina Vernes Nerisa Maiava Raelynn Mapu Shawntiarre Faumui Susitina Ene	Atene Ulimasoe Carly Toia Denis Sene Felix Penalosa June Fuifatu Lila Tuilagi Raelynn Mapu Sabrina Sulua'i Shane Chen

Courtesy of Student Services Division  
Counseling Services  
Spring 2011

	Shawntiarre Faumui		Shawntiarre Faumui		Shawntiarre Faumui
<b>2:00 – 3:00</b>	Alesana Alesana Atene Ulimasao Carly Toia Denis Lambert Denis Sene Falen Ulufaleilupe June Fuifatu Lila Tuilagi Monica Afalava Nerisa Maiava Shane Chen Shawntiarre Faumui	Alesana Alesana Monica Afalava Nerisa Maiava Sabrin Sulua'i Senetenari Malele	Alesana Alesana Atene Ulimasao Carly Toia Denis Lambert Denis Sene Falen Ulufaleilupe June Fuifatu Lila Tuilagi Monica Afalava Nerisa Maiava Shawntiarre Faumui	Alesana Alesana Monica Afalava Nerisa Maiava Sabrin Sulua'i Senetenari Malele	Alesana Alesana Atene Ulimasao Carly Toia Denis Lambert Denis Sene Falen Ulufaleilupe June Fuifatu Lila Tuilagi Monica Afalava Nerisa Maiava Shane Chen Shawntiarre Faumui
<b>3:00 – 4:00</b>	Carly Toia Denis Lambert Falen ulufaleilupe Felix Penalosa June Fuifatu Monica Afalava Sabrina Sulua'i Shane Chen Shawntiarre Faumui Susitina Ene	Alesana Alesana Karl Cayanan Monica Afalava Nerisa Maiava Raelynn Mapu Susitina Ene Victor Ualesi	Carly Toia Denis Lambert Falen ulufaleilupe Felix Penalosa June Fuifatu Monica Afalava Sabrina Sulua'i Shawntiarre Faumui Susitina Ene	Alesana Alesana Karl Cayanan Monica Afalava Nerisa Maiava Raelynn Mapu Susitina Ene Victor Ualesi	Carly Toia Denis Lambert Falen ulufaleilupe Felix Penalosa June Fuifatu Monica Afalava Sabrina Sulua'i Shane Chen Shawntiarre Faumui Susitina Ene
<b>4:00 – 5:00</b>	Victor Ualesi	Victor Ualesi Justin Tuiasosopo	Victor Ualesi	Victor Ualesi Justin T.	Office Closed
<b>5:00 – 6:00</b>	Victor Ualesi	Victor Ualesi Justin Tuiasosopo	Victor Ualesi	Victor Ualesi Justin T.	Office Closed
<b>6:00 – 7:30</b>	Victor Ualesi	Victor Ualesi Justin Tuiasosopo	Victor Ualesi	Victor Ualesi Justin T.	Office Closed

**BUSINESS COURSES TUTOR SCHEDULE SPRING 2011  
ACCOUNTING/FINANCIAL MATH/MARKETING/MANAGEMENT**

<b>Hours</b>	<b>Monday</b>	<b>Tuesday</b>	<b>Wednesday</b>	<b>Thursday</b>	<b>Friday</b>
8:00 – 9:00	Staff	Staff Justin Tuiasosopo	Staff	Staff Justin Tuiasosopo	Staff
9:00 – 10:00	Staff Justin Tuiasosopo	Staff	Staff Justin Tuiasosopo	Staff	Staff Justin Tuiasosopo
10:00 – 11:00	Staff	Staff	Staff	Staff	Staff
11:00 – 12:00	Staff Justin Tuiasosopo Susitina Ene	Staff	Staff Justin Tuiasosopo Susitina Ene	Staff	Staff Justin Tuiasosopo Susitina Ene
12:00 – 1:00	Staff Justin Tuiasosopo Susitina Ene	Staff	Staff Justin Tuiasosopo Susitina Ene	Staff	Staff Justin Tuiasosopo Susitina Ene
1:00 – 2:00	Staff Susitina Ene	Staff Justin Tuiasosopo Susitina Ene	Staff Susitina Ene	Staff Justin Tuiasosopo Susitina Ene	Staff Susitina Ene

Courtesy of Student Services Division  
Counseling Services  
Spring 2011

2:00 – 3:00	Staff Susitina Ene	Staff Justin Tuiasosopo Susitina Ene	Staff Susitina Ene	Staff Susitina Ene	Staff Susitina Ene
3:00 – 4:00	Staff	Staff Susitina Ene	Staff	Staff Susitina Ene	Staff
4:00 – 5:00	Counselor Staff	Counselor Staff Justin Tuiasosopo	Counselor Staff Justin Tuiasosopo	Counselor Staff Justin Tuiasosopo	No Evening Classes
5:00 – 6:00	Counselor Staff	Counselor Staff Justin Tuiasosopo	Counselor Staff	Counselor Staff Justin Tuiasosopo	No Evening Classes
6:00 – 7:30	Staff	Staff	Staff	Staff	No Evening Classes

**OTHER COURSES TUTOR SCHEDULE SPRING 2011**  
**AGRICULTURE/ART/ICT/HISTORY/PSYCHOLOGY/SAMOAN**

<b>Hours</b>	<b>Monday</b>	<b>Tuesday</b>	<b>Wednesday</b>	<b>Thursday</b>	<b>Friday</b>
8:00 – 9:00	Staff Amber Fuaga	Staff	Staff Amber Fuaga	Staff	Staff Amber Fuaga
9:00 – 10:00	Staff Barbara Sikoloni Amber Fuaga Nolita Motu	Staff Amber Fuaga Nolita Motu	Staff Barbara Sikoloni Amber Fuaga Nolita Motu Motusaga Vaeoso	Staff Nolita Motu	Staff Barbara Sikoloni Amber Fuaga Nolita Motu
10:00 – 11:00	Staff Barbara Sikoloni Amber Fuaga Motusaga Vaeoso	Staff Amber Fuaga	Staff Barbara Sikoloni Amber Fuaga Motusaga Vaeoso	Staff Amber Fuaga	Staff Barbara Sikoloni Amber Fuaga Motusaga Vaeoso
11:00 – 12:00	Staff Barbara Sikoloni Motusaga Vaeoso	Staff Amber Fuaga Denis Sene	Staff Barbara Sikoloni Motusaga Vaeoso	Staff Amber Fuaga Denis Sene	Staff Barbara Sikoloni Motusaga Vaeoso
12:00 – 1:00	Staff Maylise Vai	Staff Amber Fuaga	Staff Maylise Vai	Staff	Staff Maylise Vai
1:00 – 2:00	Staff Maylise Vai	Staff Barbara Sikoloni Motusaga Vaeoso Carly Toia	Staff Maylise Vai	Staff Amber Fuaga Barbara Sikoloni Motusaga Vaeoso Denis Sene	Staff Maylise Vai

Courtesy of Student Services Division  
Counseling Services  
Spring 2011

2:00 – 3:00	Staff Amber Fuaga	Staff Motusaga Vaeoso Carly Toia	Staff Amber Fuaga	Staff Amber Fuaga Motusaga Vaeoso Denis Sene	Staff Amber Fuaga
3:00 – 4:00	Staff Maylise Vai	Staff Motusaga Vaeoso Carly Toia	Staff Maylise Vai	Staff Amber Fuaga	Staff Maylise Vai
4:00 – 5:00	Counselor Staff	Counselor Staff	Counselor Staff	Counselor Staff	No Evening Classes
5:00 – 6:00	Counselor Staff	Counselor Staff	Counselor Staff	Counselor Staff	No Evening Classes

## TAX FILING!

**Have you filed your taxes yet? If not, please see Ms. Athena Mauga @ the Business Department for more information on how the process works, or contact her at 699-9155 ext. 382**



## **GRAFFITI is a SERIOUS VIOLATION!**

**Violators will be dealt with according to the policies and Regulations governing ASCC**

## CAMPUS SECURITY INFORMATION:

Business Hours:	699-9155 ext.305
After hours or before 7:30am:	699-6299

## REMINDER: ZERO TOLERANCE POLICY

**Students! Please know and understand that this policy is very crucial.**

**If you have any questions regarding this policy, please refer to the ASCC Catalog (hard copy or ASCC Website), or see the Dean of Student Services.**

## ASCC Fall 2010 Tutorial Directory

<b>Divisions/ Departments/ Special Projects</b>	<b>Subjects</b>	<b>When?</b>	<b>Where?</b>	<b>Coordinator / Contact Person</b>
Division of Student Services / (SLAC)	All courses as needed	Daily / Scheduled by Appointment	Student Learning Assistance Center (SLAC)	Deidra Saelua 699-9155 ext 461 d.saelua@amsamoa.edu
Art Department	Drawing; Designing; Painting; Photography; Pottery	Scheduled by Appointment	Art Department	Regina Meredith 699-9155 ext 360 r.meredith@amsamoa.edu
Business Department	Accounting; Financial Math; Business Plan	See Instructors/ Office Hours	Business Department	Faofua Faatoafe 699-9155 ext 319 faatoafe.faofua@amsamoa.edu
Community and Natural Resources (CNR)	AGR100 I & II; AGR197; AGR250; AGE150; AGR152; AGR297/MSC197; ANS150A; ANS150B; FAM250; FAM260; NRS180; NRS200; NRS250; NUT150	Scheduled by Appointment	Community & Natural Resources Rm	Tavita Elisara 699-1575 t.elisara@amsamoa.edu
ELI / Student Support Services	English and Math Courses (ELI)	Daily: 8am-3pm	SSS Building (Old Library)	Lea Fotuali'i 699-9155 ext 423 l.fotualii@amsamoa.edu
GEAR UP Office	Math /Autodesk	Daily: Scheduled by appointment	TTD Lab Gear Up Office	Roy Fua 699-9166 r.fua@amsamoa.edu
Language and Literature Department	Writing; Reading; Interpretation; Research	Daily / Office hours	Instructor's Offices	Mele Fiaui 699-9155 ext. 345 m.fiaui@amsamoa.edu
Math and Science Departments (LSAMP Program)	All Math and Science Courses	Daily / Scheduled by Appointment	SLAC & Chemistry Lab	Victor Ualesi 699-9155 ext356 v.ualesi@gmail.com

Courtesy of Student Services Division  
Counseling Services  
Spring 2011



Music Department	MUS161; MUS153; MUS296&L; MUS160	Daily / Office hours	Instructor's Offices	Kuki Tuiasosopo 699-9155 ext450 k.tuiasosopo@amsamoa.edu
Nursing Department	Health (Nursing)	Scheduled by Appointment	See Instructors	Lele Ah Mu 699-1586 l.ahmu@amsamoa.edu
Samoan Studies Institute	All Samoan Courses	<u>Office Hours:</u> Scheduled by Appointment	Samoan Studies Institute (Office hours)	Hannacho Sione 699-9155 ext347 h.sione@amsamoa.edu
Teacher Education Department	English; History; Math; Speech; Science, etc	Scheduled by Appointment	(SLAC) Student Learning Assistance Center	Laura Purcell 699-9155 ext431
Trades & Technology Division	Vocational Trades	Daily / Office hours	TTD Classrooms	Sal Poloai 699-9155 ext325 s.poloai@amsamoa.edu
Upward Bound	English; Math; Science	Scheduled by appointment	UB/ELI Classes	Peka Leuma @ 699-9155 ext. 338 e.leuma@amsamoa.edu



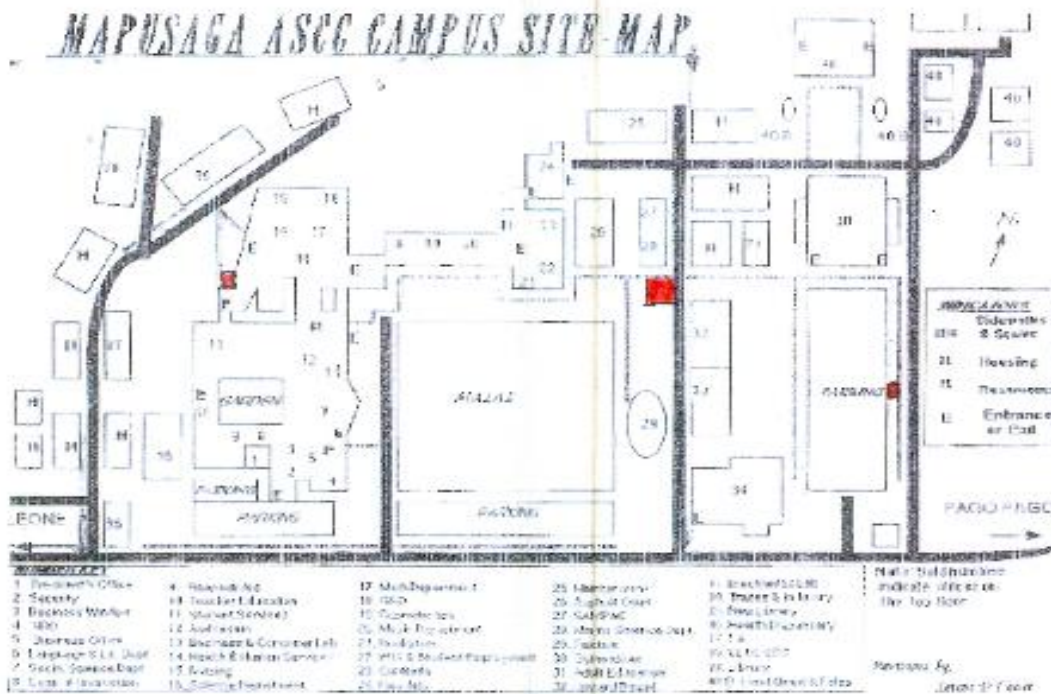

# SMOKING AREAS

In accordance with the American Samoa Code § 13.1306, and ASCC policy: smoking is strictly prohibited, except in designated smoking areas.



Violators of the law may be fined up to \$50.00; employee violators may be disciplined under the ASCC Personnel Manual; and student violators may be disciplined by ASCC Student Services. ASCC reserves the right to treat violators, of the law and the ASCC policy, as trespassers, and escort the violators off the premises.

Counseling Services  
 Spring 2011